

# Accommodation Fact Sheet

SHOAL BAY  
RESORT & SPA



# Accommodation

## FACT SHEET

### The Heritage Suite Apartments



For the astute traveller the 5 star Heritage Suite Apartments offer all the luxuries of 5 star accommodation with room service, fully stocked mini bar, leather furnishings, plasma screens and DVD player. Bathrooms are luxurious and well designed, featuring corner spas and walk in showers suitable for the experienced traveller or just those wishing to indulge in pure luxury for a special occasion will enjoy beach front views in Heritage suite apartments.

<b>ONE Bedroom</b>	<b>26</b>	<b>TWO Bedroom</b>	<b>1</b>
Lounge	✓	Lounge	✓
Dining	✓	Dining	✓
Full Kitchen	✓	Full Kitchen	✓
Bathroom	✓	Bathroom	✓
Spa Bath	✓	Spa Bath	✓
Ensuite	✓	Ensuite	✗
Full or Juliet Balcony	✓	Full or Juliet Balcony	✗
Sofa Bed	✗	Sofa Bed	✗
Security Parking	✓	Security Parking	✓
Views	✓	Views	✗

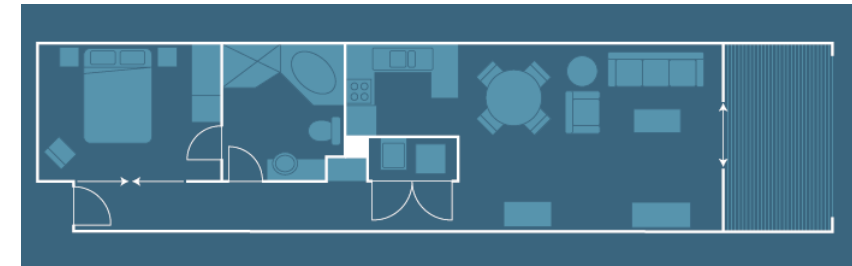

# Accommodation

## FACT SHEET

### The Barrington Apartments



Barrington Apartments are modern and fresh in style. The one, two and three bedroom, self contained apartments feature open lounge, kitchen and dining area, the majority with spa bathrooms and balconies to capture views out to the ocean or across to the National Park. A favourite for families and couples, Barrington Apartments provides the ideal getaway to relax.

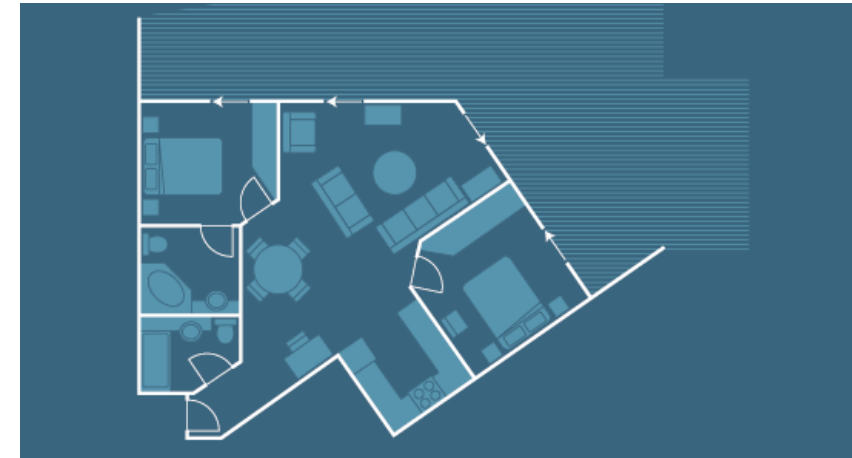

#### ONE Bedroom

Lounge  
Dining  
Full Kitchen  
Bathroom  
Spa Bath  
Ensuite  
Full Balcony  
Sofa Bed  
Security Parking  
Views

#### 38 TWO Bedroom

✓ Lounge  
✓ Dining  
✓ Full Kitchen  
✓ Bathroom  
✗ Spa Bath  
✗ Ensuite  
✓ Full Balcony  
✓ Sofa Bed  
✓ Security Parking  
✓ Views (19)

#### 22 THREE Bedroom

✓ Lounge  
✓ Dining  
✓ Full Kitchen  
✓ Bathroom  
✓ Spa Bath  
✓ Ensuite  
✓ Full Balcony  
✗ Sofa Bed  
✓ Security Parking  
✓ Views

#### 1

✓ Lounge  
✓ Dining  
✓ Full Kitchen  
✓ Bathroom  
✓ Spa Bath  
✓ Ensuite  
✓ Full Balcony  
✗ Sofa Bed  
✓ Security Parking  
✗ Views



# Accommodation

## FACT SHEET

### Seaspray Villas



The perfect balance of space and outdoor entertaining, Seaspray Villa's are modern and spacious. Adjacent to the \$5.5 million Aqua Spa facility this accommodation is perfect for a group of friends on an Aqua Spa retreat. Two double bedrooms, one with ensuite bathroom and a second bathroom. Full kitchen facilities and spacious terraces extend the dining and living area to take advantage of the water views across Shoal Bay and Mount Tomaree.



#### TWO Bedroom

- |                  |   |
|------------------|---|
| Lounge           | ✓ |
| Dining           | ✓ |
| Full Kitchen     | ✓ |
| Bathroom         | ✓ |
| Spa Jets         | ✓ |
| Ensuite          | ✓ |
| Full Balcony     | ✓ |
| Sofa Bed         | ✗ |
| Security Parking | ✓ |
| Views            | ✓ |

9

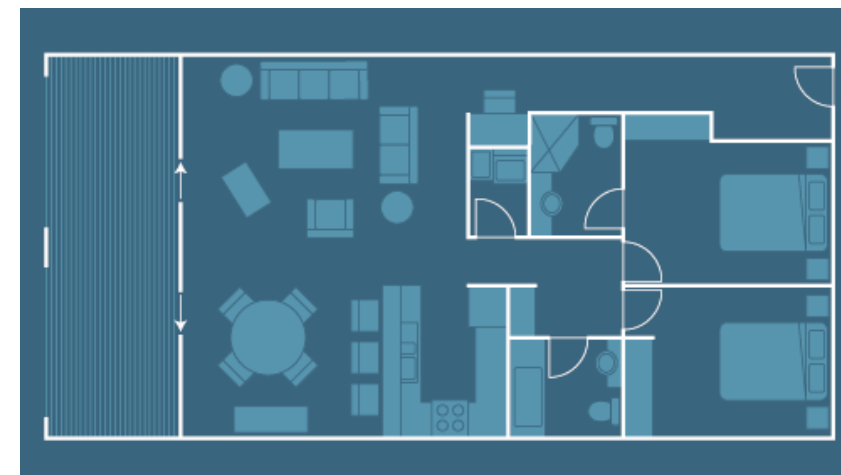

# Accommodation

## FACT SHEET

### Whitesands Apartments



Whitesands Apartments are a stones throw from Shoal Bay Beach and encompasses a variety of facilities including the Whitesands convention centre, Sandy Foot Café & Sandy Foot Bar. Whitesands Apartments offer one and two bedroom self contained apartments. Popular with guests conveniently located to all resort facilities, Shoal Bay Beach at your door step and the Shoal Bay Village.

<b>ONE Bedroom</b>	<b>37</b>	<b>TWO Bedroom</b>	<b>8</b>
Lounge	✓	Lounge	✓
Dining	✓	Dining	✓
Kitchenette	✓	Kitchenette	✓
Bathroom	✓	Bathroom	✓
Spa (32)	✓	Spa Bath	✓
Ensuite	✗	Ensuite	✓
Full or Juliet Balcony	✓	Full or Juliet Balcony	✗
Sofa Bed	✓	Sofa Bed	✗
Security Parking	✓	Security Parking	✓
Views (19)	✓	Views (2)	✓



# Accommodation

## FACT SHEET

### Breakwater Apartments



With its own private pool and spa, recreation room and a choice of two or three bedrooms, Breakwater Apartments are the ultimate address in Port Stephens. Encompassing views high across Shoal Bay towards Myall National Park, apartments feature living area, separate dining area and full kitchen. Main bedrooms have ensuites, plus full second bathroom. Oversized balconies ensure guests take full advantage of the spacious apartments.

#### TWO Bedroom

Lounge  
Dining  
Full Kitchen  
Bathroom  
Spa Bath  
Ensuite  
Full Balcony  
Sofa Bed  
Security Parking  
Views

10

✓  
✓  
✓  
✓  
✓  
✓  
✓  
x  
✓  
✓

#### THREE Bedroom

Lounge  
Dining  
Full Kitchen  
Bathroom  
Spa Bath  
Ensuite  
Full Balcony  
Sofa Bed  
Security Parking  
Views

13

✓  
✓  
✓  
✓  
✓  
✓  
✓  
x  
✓  
✓



# Accommodation

## FACT SHEET

### Zenith Rooms



Motel style accommodation with separate entrance is the answer for travellers on a budget. These comfortably appointed studio rooms can sleep up to 4 guests and include tea/coffee making facilities, bar fridge and microwave.

<b>STUDIO</b>	<b>5</b>	<b>ONE Bedroom</b>	<b>7</b>
Lounge - Open Plan	✓	Lounge	✓
Dining	✓	Dining	✓
Kitchenette	✓	Kitchenette	✓
Bathroom	✓	Bathroom	✓
Off street parking	✓	Off street parking	✓

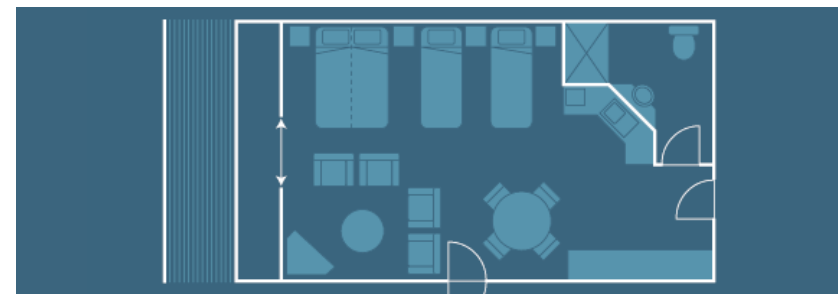

# Accommodation

## FACT SHEET

### Poolview Rooms

Overlooking the lagoon style resort pool with its own beach and wading area. These 4.5 star studio hotel rooms are the perfect solution for a short getaway, travelling on business or those looking for great value. Centrally located, sleeping up to 3 guests including bathroom, tea/coffee making facilities, bar fridge and microwave.



<b>STUDIO</b>	<b>12</b>
Dining	✓
Kitchenette	✓
Bathroom	✓
Patio (6)	✓
Security Parking	✓

